

ELECTRIFIED LOCKSETS

7800 Selectric™ Locksets



Building and Fire Safety code compliant for fire rated doors. The door stays latched even when unlocked, maintaining fire door integrity. Applications include: Office doors, stairwell doors, exit doors, lobby doors, corridors doors.

- SDC manufactured locks
- New or Retrofit Application
Replaces moss mechanical locks
- Field Selectable Mode
Failsafe or Failsecure
- Field Selectable Voltage
12 or 24 VDC
- Field Selectable Hand
LH, RH, LHR, RHR
- Proprietary Clutch
Vandal resistant lever handles
- Select Trim Brand
Order with SDC trim or less trim
Compatible with Schlage lever trim
- Key Latch Retraction
- ANSI/BHMA Grade 1 Compliant
- UL Listed for 3 Hr. 'A' Label Fire Rated Doors

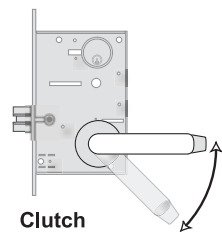

Vandal Resistant Lever Handles Standard with SDC Brand Lockset
When locked, the built-in clutch permits the handles to operate without retracting the latch, reducing potential for damage.



Choice of Function:

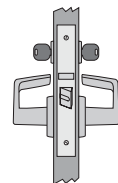

Locked From Both Sides
Unlocked by an access control, remote control or key from either side. Field selectable.



Locked From Outside Only
Unlocked by an access control or key from the outside. Uninhibited egress at all times by turning the inside lever handle. Field selectable.

Part No.	Description
SDC Z7852 E 630 12/24 VDC	-----Complete Lock, Eclipse Trim
SDC Z7852 630 12/24 VDC	-----Lock Body, Less Trim

7500 Series HiTower® Electrified Locksets

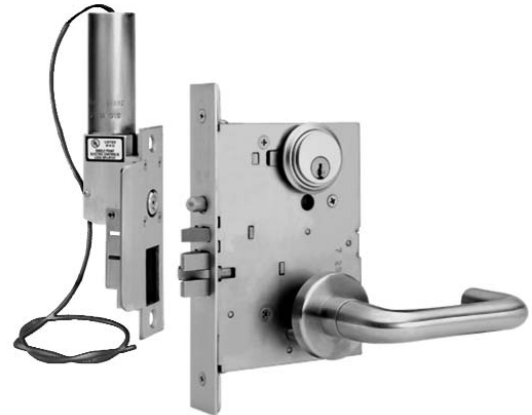

SDC's patented and UL listed HiTower® locks have an actuator that will fit into an ASA prepped 1 3/4" frame. It is the only lock of this type that can deadlock the mortise lock directly by the actuator with no auxiliary deadlocking cam linkage required. This simplified action adds both greater security and increased reliability. With the SDC modified mortise lock on the door and the actuator in the frame, there is no electric mortise lockset and no wiring through the door. While providing controlled access and remote control capability the door stays latched even when unlocked, maintaining fire door integrity.

Features:

- No power transfer hinge required on single doors.
- Fail-safe operation
- Spring located hub locking mechanism absorbs pressure for smooth lever action
- Actuator assembly is sealed
- No internal working parts are exposed
- Actuator mechanism does not project beyond frame
- No electric bolt to bind or jamb due to door misalignment
- ANSI 156.13 Grade 1
- Backset: 2.75"
- Minimum door thickness: 1.75"
- Stocked with a Schlage L9080 mortise lock
- Supplied less cylinders

Functions:

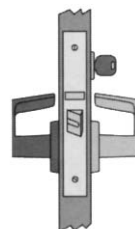

Locked outside only, free egress from the inside
Locked when energized, unlocked by an access control, key from the outside. Uninhibited egress at all times by rotating the inside lever.
Suggested use: Stairwell doors, lobby doors, exit doors, inner offices, safety mantraps, communicating bathrooms

Part No.	Description
SDC S7550L AQ	-----Left Hand, 115VAC, Satin Chrome finish
SDC S7550R AQ	-----Right Hand, 115VAC, Satin Chrome finish
SDC S7550L CQ	-----Left Hand, 24VDC, Satin Chrome finish
SDC S7550R CQ	-----Right Hand, 24VDC, Satin Chrome finish

ELECTROMAGNETIC LOCKS

Micro/Shear® Electromagnetic Lock



SDC's model 1561-ITCM Micro Shear Magnetic Lock offers 2000 lbs. of tensile holding strength, enough to withstand an attack that will destroy or deform a door. The design combines aesthetics, high security and performance. Capable of being concealed in the mortise of the frame header. Lateral armature alignment adjustment can compensate for minor warped or misaligned doors. Vertical armature positioning is also field adjustable to help insure positive relocking without use of shims. Reliable performance in high frequency openings. Fail-safe operation. Equipped with a built-in auto relock switch and time delay which delays relocking 1 to 5 seconds (field adjustable). After initial door closure, the door is fully closed and at rest to attain optimum alignment before lock is energized. 12/24 VDC.

Part No.
SDC 1561 ITCM

POWER SUPPLIES

602RF Series Modular Power Supply



The SDC 602RF power supply is equipped with a high performance PC board mounted transformer and highly reliable electronic components which must pass rigid quality control standards. Although designed to fulfill the need for small economy installations, this product includes voltage regulation and filtering and battery charging circuitry. The output voltage is field selectable for 12 or 24VDC with a 1 AMP Class 2 output. SDC power supplies are built to protect and ensure the longevity of all security components.

Features:

- The AC input is protected by a circuit breaker and the output voltage is protected by a poly fuse
- Fire Panel Emergency Lock Release Input: Fail safe locks and/or door holders are released by a signal from the fire panel. The input may be used for Main System On-Off by a remote switch, time clock or Access Control for fail safe or fail secure locking devices
- Supplied with an 11¹/₂" × 1¹/₂" × 3¹/₂" enclosure

Part No.: SDC 602RF

631RF Series Modular Power Supply



The SDC 631RF Power Supply has regulated and filtered output voltage. The solid state regulator maintains the selected output voltage at 12 or 24VDC (at 1.5 AMPS) up to the rated output load current regardless of the load current changes. The output filtering stabilizes the DC output voltage and eliminates AC line noise. The built-in battery charger circuitry eliminates the need for additional boards and provides the required 13.8VDC or 26.5VDC at a separate output terminal to charge the batteries, providing continuous operation of locking devices and other access equipment during a power failure. The AC input line voltage is fused and the output voltage is protected by a circuit breaker, with an additional output fuse for battery protection.

Features:

- Heavy duty electrical components
- Field selectable: 12VDC or 24VDC @ 1.5 amps
- Build-in battery charger included
- Supplied with an 11¹/₂" × 1¹/₂" × 3¹/₂" enclosure

Part No.
SDC 631RF
Backup Battery For 602RF and 631 RF
Part No.: SDC RB12V4

Transformer



Plug-in type transformer. 120VAC primary, secondary screw terminals with ground terminal.
Output 1: Fused unregulated 12VDC @ 780 ma.
Output 2: Regulated 12VDC @ 150 ma.

Part No.: SDC TR12

Switch Bars



The SDC MSB550 mechanical switch bar is designed to release magnetic locking devices or use as a monitor device to activate or shunt an alarm. Triggered with minimal movement when the bar is depressed (less than 1/8").

Constructed using an exclusive heavy-duty aluminum extrusion and rugged molded end caps. The mounting assembly is all metal, no plastic. The rigid construction prevents any malfunction due to sagging or warped doors or tweaked-glass door stiles. Designed for high frequency usage on any type of door. 2 switches, SPDT 5 AMP @ 125VAC.

Part No.	Description
SDC MSB550 2V 36	Aluminum finish, 36" door
SDC MSB550 2V 48	Aluminum finish, 48" door
SDC MSB550 2X 36	Dark Bronze Duranodic finish, 36" door
SDC MSB550 2X 48	Dark Bronze Duranodic finish, 48" door

POWER SUPPLIES

Power Transfer



Armored 18" stainless steel flex conduit, less wiring, to supply power to an aluminum frame or hollow metal door for switch bars or other electrical devices.

Part No.
SDC PT 2

ACCESS CONTROLS

917 Entry Check



The SDC 917 consists of a 12 digit keyboard and an on board microprocessor with non-volatile memory. The microprocessor controls the advanced features of the keypad and all programming options. Four separate outputs are controlled by 160 user codes (of 3 to 6 digits) and two additional inputs generating one million possible combinations. Add a magnetic door switch and the door ajar and time cancel features become usable.

Features:

- Two relay outputs
- Two voltage outputs
- Codes stored in EEPROM memory cannot be lost in power failure
- Immune from electromagnetic interference
- 12/24VAC-DC, stainless steel finish

Part No.
SDC 917

950 Entrycheck™ Proximity/PIN Reader



The SDC 950C is a self-contained, stand alone proximity reader and PIN pad. Designed for the most basic access control applications, it is easy to install, program and operate. The basic operation and simplicity make it ideal for entry level applications at a reasonable cost. Incorporates all the logic necessary to control a single door. Programming is performed by using the built-in keypad. Key fobs, card and PIN entries can be added or deleted with the keypad using the master code or programming card.

Features:

- Up to 400 Users
- Programmable door unlock time from 1–99 seconds
- LED and audible tone for operation ease
- Weather resistant
- Supplied with 10 key fobs

Part No.: SDC 950C

SDC 950 Accessories



Part No.	Description
SDC C10	Pack of 10 Cards



Part No.	Description
SDC K10	Pack of 10 Key Fobs

KEY SWITCHES, EXIT BUTTONS

700 Series Key Switches

The SDC 700 Series Key Switches are intended for industrial/commercial use. Compatible for 1 1/8" and 1 1/4" mortise cylinder (not included). Adjustable switch position for cylinder compatibility. Large actuator assembly for positive circuit activation. 20 gauge stainless steel, wall mounted, fits a single gang mortise or surface mounted box.



Narrow 1 3/4" Faceplate

Part No.	Description
SDC 701NU 6	On-Off SPDT Switch
SDC 702NU 6	Momentary SPDT Switch



27/8" Faceplate

Part No.	Description
SDC 701U 6	On-Off SPDT Switch
SDC 702U 6	Momentary SPDT Switch

KEY SWITCHES, EXIT BUTTONS

Exit Buttons

The SDC 400 Series Exit Buttons are intended for use as on-site remote door controls and status indicators. Designed for aesthetic and technical compatibility with other widely used components, these switches provide efficient door controls for many applications. 20 gauge satin stainless steel finish



Part No.	Description
SDC 401U	Maintained SPDT Switch 3/4" Square
SDC 402U	Momentary SPDT Switch 3/4" Square



"Exit" engraved button

Part No.	Description
SDC 422GE	Momentary SPDT Switch, 2" Square

ACCESSORIES

Emergency Door Release



The SDC 491A "Break Glass" emergency door release is ideal for immediate unlocking of perimeter doors or interior work area doors that are equipped with fail-safe electric locks. Blue painted finish with easy to read activation instructions avoids confusion with red fire alarm stations. Aluminum rod for striking glass included (not required to break the glass).

Features:

- May initiate the release of an individual door or all doors connected to the Electric Locking System
- Can be flush or recessed mounted in a 2" single gang box or double gang box with a plastic ring cover
- Two replacement glass plates included
- UL Listed and CSFM - California State Fire Marshal Listed

Part No.
SDC 491A

Motion Detector



The SDC31D passive infrared detector is specifically designed for request-to-exit applications. It has an adjustable 1–60 second time delay. The coverage field is internally pointable. When angled 14 degrees down, coverage may be 5' x 6' at 7' high to 10' x 12' at 15' high. It projects in a "U" pattern down and away from the door to inhibit tampering. Can be mounted to the frame header, wall or ceiling.

Features:

- Fail-safe or Fail-secure mode selection
- Complies with NFPA applications
- Input: 12 or 24VDC @ 26mA max
- Contact: 2 SPDT Dry, 2 AMP @ 30VDC
- Color: Off White

Part No.
SDC MD 31D OW